

Coakley Middle School

Norwood Public Schools

Community Forum #5

September 23, 2021

Middle School Building Committee

Alan Slater	Chair
Myev Bodenhofer	School Committee member
Cathy Carney	MCPPO – Contract Administrator
Diane Ferreira	Principal of Balch Elementary School
Dr. Margo Fraczek	Principal of Coakley Middle School
Matt Lane	Selectman
Tom Maloney	Selectman
Tony Mazzucco	General Manager
Paul Riccardi	Director of Buildings and Grounds
Teresa Stewart	School Committee member
Dr. David Thomson	Superintendent
Matthew Walsh	Building Commissioner

Architect

Ai3 Architects, LLC

OPM

COMPASS Project Management, Inc.

In partnership with the
Massachusetts School Building Authority



Agenda

September 23, 2021

- ◆ **Introductions**
- ◆ **Agenda**
- ◆ **Project Schedule & Next Steps**
- ◆ **Design update**
 - ◇ Floor Plans
 - ◇ Site Plan
 - ◇ Exterior Renderings
- ◆ **Questions & Answers**



MSBA Masterplan & Building Process

MSBA Masterplan Process



MSBA Building Process

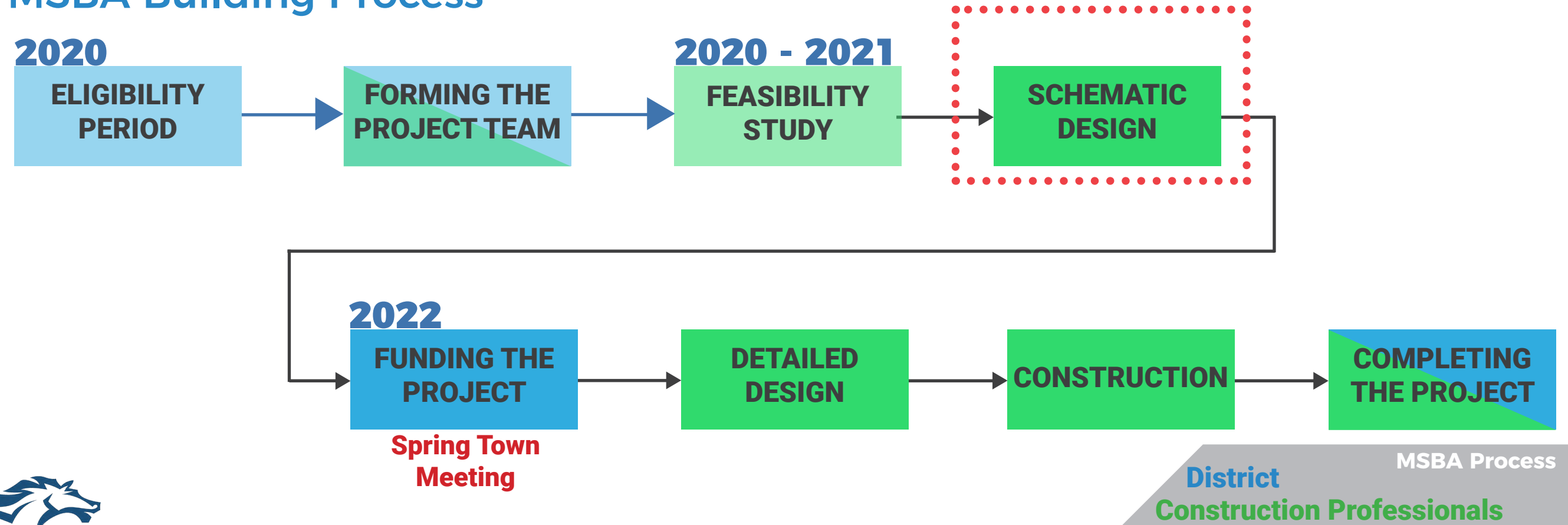

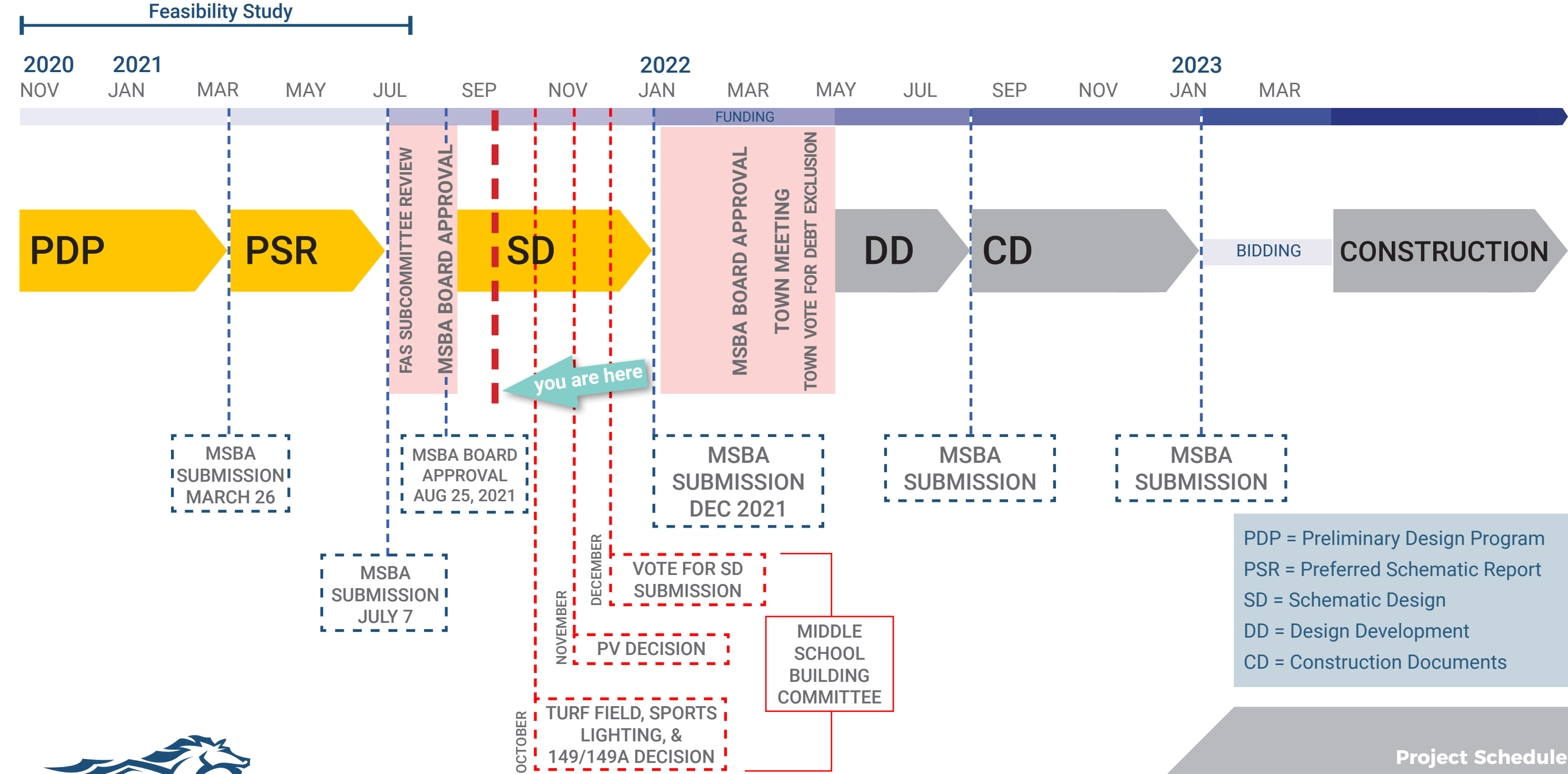

Project Schedule

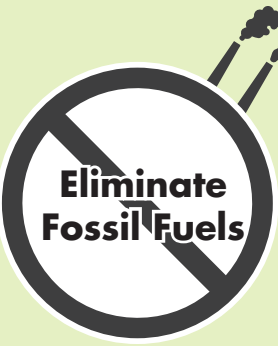

NET ZERO & SUSTAINABLE DESIGN

PATH TO NZE

1  **Eliminate Fossil Fuels** Design an all electric building

2  **Reduce Demand** Target a low EUI

3  **Produce Electricity On-Site**

New **Coakley Middle School** anticipated annual energy consumption:

1,376,400 kWh

Required PV to offset building use

- Approximately 30,000 sf of panels on the roof
- Approximately 30,000 sf of panels over parking spaces



Table of Contents

4.1.1 INTRODUCTION

- Summary of Preferred MSBA Board Selection*
- Overview of Process*
- Description of Project*
- Graphic & Visual Aids*
- MSBA Review & District's Response to PSR Report*

4.1.2 PROJECT CONTACTS, COMMUNICATIONS & PROCEDURES

- Project Directory*
- Roles & Responsibilities*
- Communications & Documentation Control Procedures*
- Work Plan*
- Updated Project Schedule*

4.1.3 FINAL DESIGN PROGRAM

- Architectural Characteristics*
- Site Development Description*
- Design Focal Point*
- Functional Relationships & Adjacencies*
- District's Educational Program & Design Response*
- Existing & Proposed Technology*
- Security & Visual Access*
- Space Summary Narrative*
- Designer Certification*
- Educational Space Summary*

4.1.4 SITE ANALYSIS

- Traffic Analysis*
- Phase 1 Environmental Assessment*
- Geotechnical Report*

4.1.5 CODE ANALYSIS

- Building Code Analysis*
- Compliance with ADA & MAAB*

4.1.6 UTILITIES & SOILS ANALYSIS

4.1.7 MASSING STUDY

4.1.8 BUILDING SYSTEMS DESCRIPTIONS

- Building Structure*
- Electrical Systems*
- Mechanical Systems*
- Plumbing Systems*
- Fire Protection Systems*
- Information Technology Systems*
- Theater Equipment*
- Foodservice Equipment*

4.2.1 SUSTAINABLE BUILDING DESIGN

- LEED Scorecard*
- Designer's Certification Letter*

4.3.1 ROOM DATA SHEETS

4.4.1 PROPOSED CONSTRUCTION METHODOLOGY

4.4.2 ANTICIPATED REIMBURSEMENT RATE

4.4.3 TOTAL PROJECT BUDGET

4.4.4 COST ESTIMATES

- Cost Comparison*
- Designer's Cost Estimate*
- OPM's Cost Estimate*

4.4.5 PROPRIETARY PRODUCTS

4.5.1 LOCAL ACTIONS & APPROVALS

- Local Actions and Approvals Letters*
- Certification Letter*
- Middle School Building Committee Meeting Minutes*
- School Committee Meeting Minutes*
- Community Forum Information*

APPENDICES

- A. DESE Submission**
 - OPM DESE Review Cover Letter*
 - Special Education Delivery Methodology*
 - Signed Education Space Summary*
 - Special Education Adjacency Table*
 - Preliminary Floor Plans*

B. MA Historical Commission Submission

Dark Gray - Items related to the Building Option that is required for submission

Light Gray - Items submitted in previous PSR report that are required to be submitted again



PREVIOUS PROJECT PHASE (PSR)

ADD/RENO



option 2A
2-story

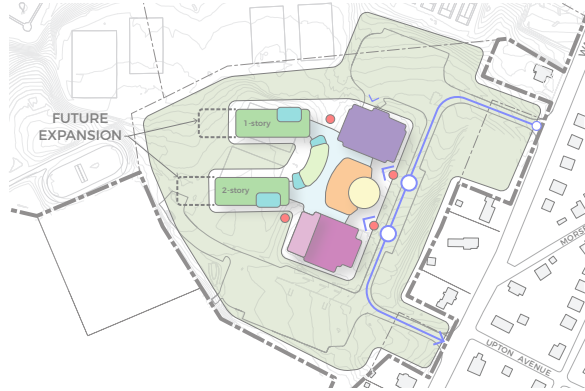

NEW



option 3A - stepped
3/4-story

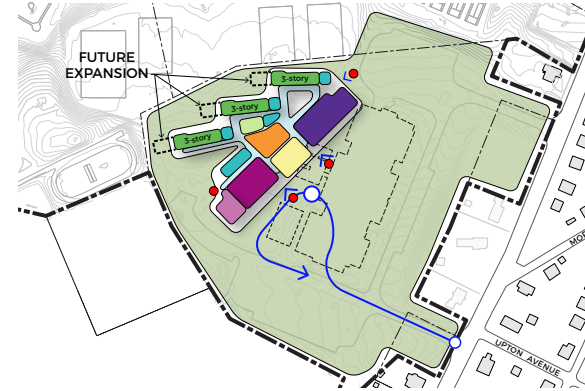

option 3B - 2 wings
2-story



option 3C - 2 wings phased
2-story



BASE REPAIR



option 1
2-story

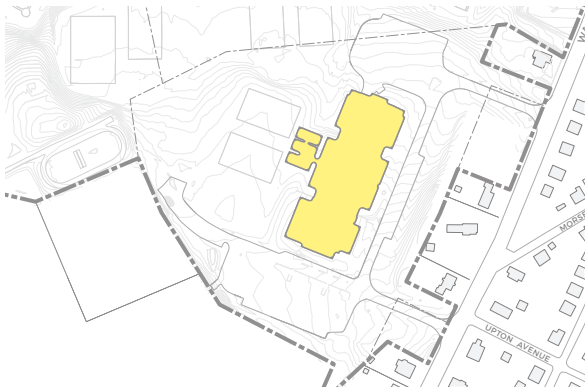

option 3D - backwards "C"
2-story



option 3E - angle
3/4-story

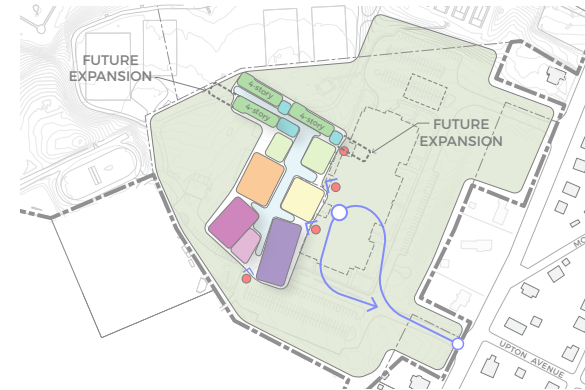

option 3F - linear
3/4-story







option 3H - hybrid
3/4-story

PREVIOUS PROJECT PHASE (PSR)

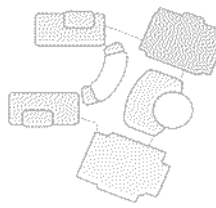
Coakley Middle School Project
Norwood Public Schools, Norwood MA
School Building Committee

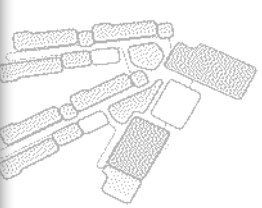
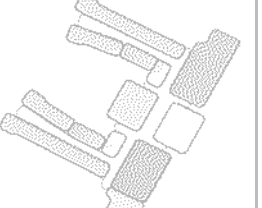
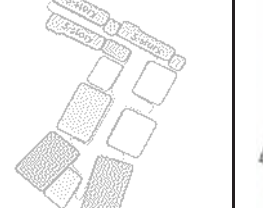
Project Evaluation Criteria Matrix

	Option 1	Option 2A	Option 3A Stepped	Option 3B 2 Wings	Option 3C 2 Wings / Phased	Option 3D Backwards "C"	Option 3E Angle	Option 3F Linear	Option 3H Hybrid
									
	Base Repair	Add/Reno	New 4 Story	New 2 Story	New 1/2 Story 2 Phase	New 1/2 Story	New 3/4 Story	New 4 Story	New 4 Story
Supports Education Program									
Project Cost	\$70.4 mil	\$128.3 - \$145.3 mil	\$131.4 mil	\$131.5 mil				\$130.8 mil	\$130.8 mil
Construction Duration / Phasing			32 months	32 months				32 months	32 months
Impact to Existing School									
Impact to Existing Fields & Greenspace									
Traffic / Site Circulation									
Community Use / Accessibility									
Educational Space Daylighting									

BEST	GOOD	FAIR	POOR	WORST
------	------	------	------	-------

Middle School Building Committee voted on June 21 to move forward with Option 3A as the Preferred Option.



FLOOR 1

GRADE 5

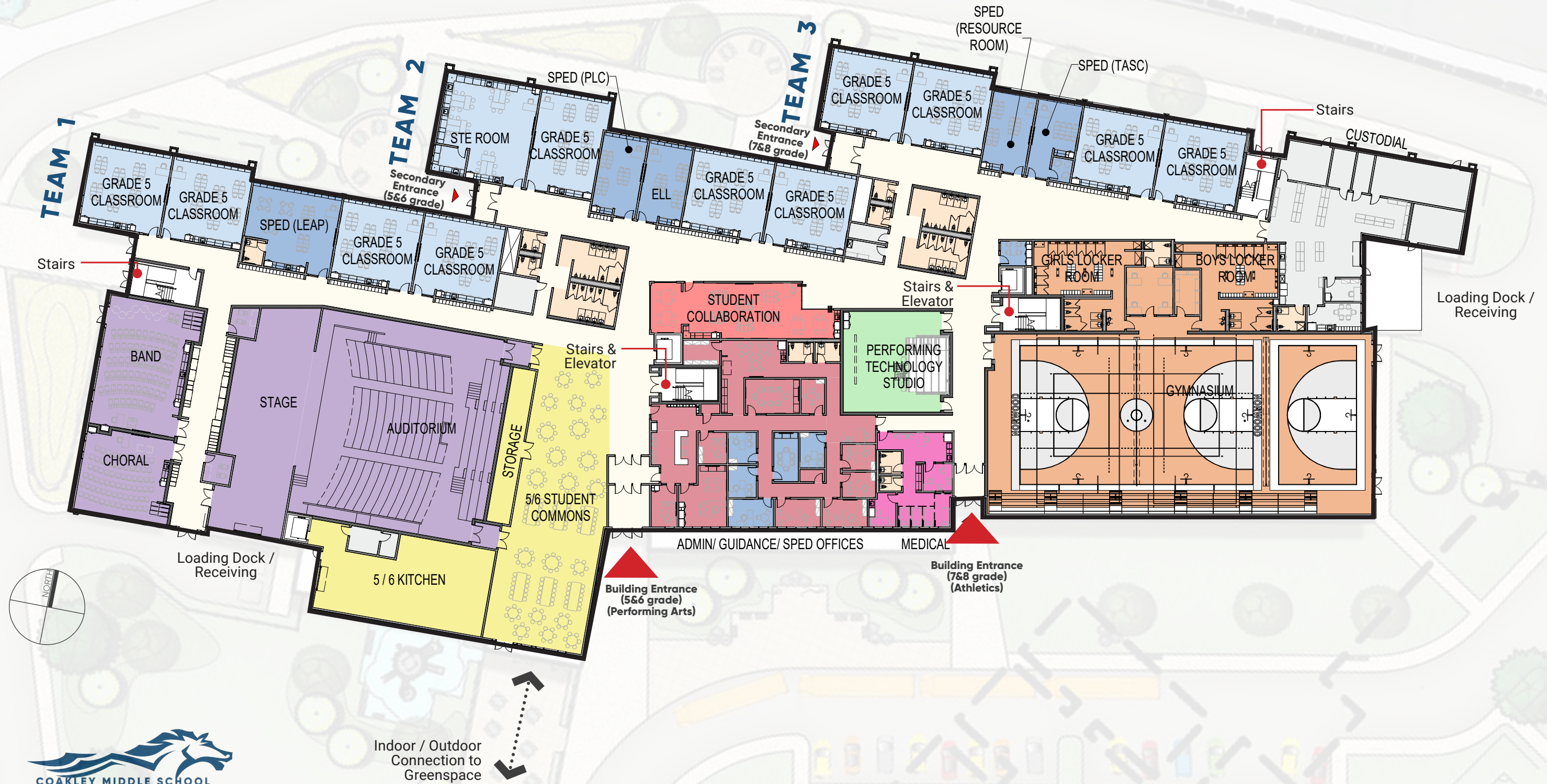

FLOOR 2

GRADE 6



FLOOR 3

GRADE 7



FLOOR 4

GRADE 8





BIG BLOCK WALLS

STONE VENEER WALL

ATHLETIC STORAGE

STONE VENEER WALL

RAIN GARDEN

PATH TO FIELDS

DECORATIVE PAVEMENT RAIN GARDEN

RAIN GARDEN

GREENSCREEN FENCING

SERVICE

BERM

5TH GRADE PLAYGROUND

SIGN

LARGE SHADE TREE

BUS PARKING

ATHLETIC STORAGE

GREENSCREEN FENCING

SERVICE

OVERFLOW PARKING

SIGN

ATHLETIC STORAGE

MEDIUM SHADE TREE
ORNAMENTAL BENCH

BUFFER PLANTING

DECORATIVE PAVING

FLAG POLE
ORNAMENTAL BENCH

STUDENT COMMONS PLAZA

BERM

SIGN



Design Overview

This presentation will:

- ◆ Describe the **UNIFYING** elements of the new Coakley Middle School design and their importance in the history of Norwood.
- ◆ Reflect on existing buildings within the community to establish **DESIGN PARAMETERS**. These parameters will be used to redefine the limits of traditional architecture to establish the Coakley Middle School as a 21st Century learning environment.
- ◆ Review massing, materials, textures, and colors and how these critical **BUILDING ELEMENTS** are integrated into the design.
- ◆ Discuss how taking cues from the past, while looking ahead to the future materializes into a 21st Century Middle School specifically **TAILORED TO THE NORWOOD COMMUNITY**.

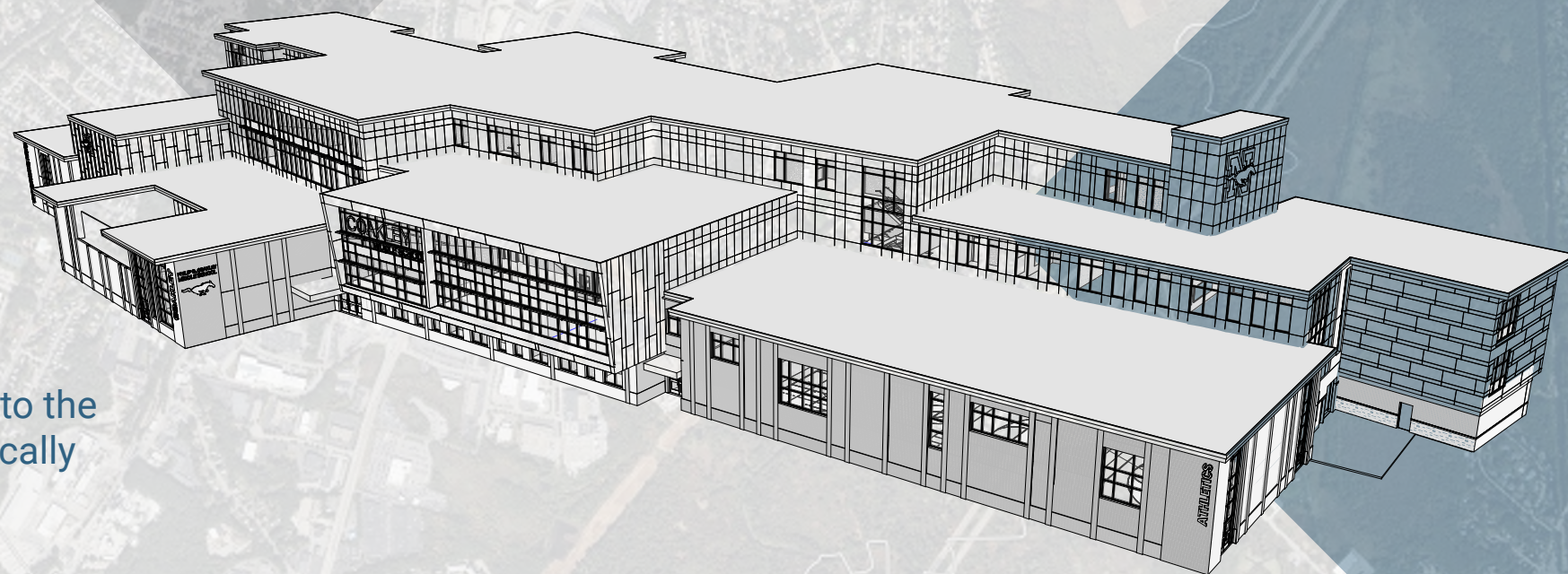

Unifying Element

Industrialization -> Mill Buildings

“The industrialization of Norwood is the most significant and distinctive feature of its history. Beginning in the mid-19th century, local tanneries, printing presses, ink manufacturers and other industries helped transform Norwood into a booming and ethnically-diverse industrial town.” *Norwood Historical Society*



NORWOOD HIGH SCHOOL



THE NEW COAKLEY
MIDDLE SCHOOL



BALCH ELEMENTARY SCHOOL

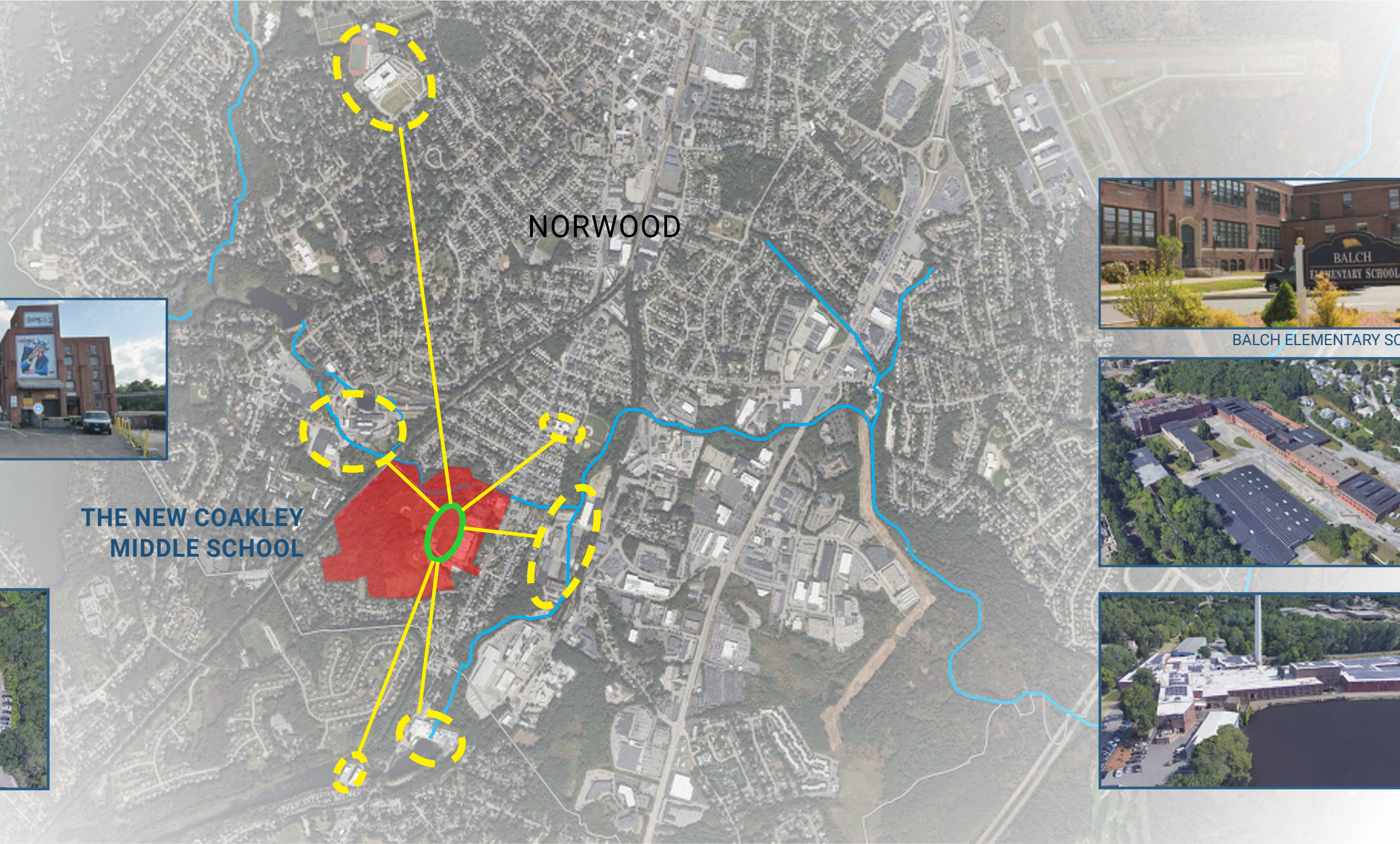







Existing Building Reflection

Patterns & Repetition



WHAT IS THE STRUCTURAL GRID AND BAY SPACING AND WHY?

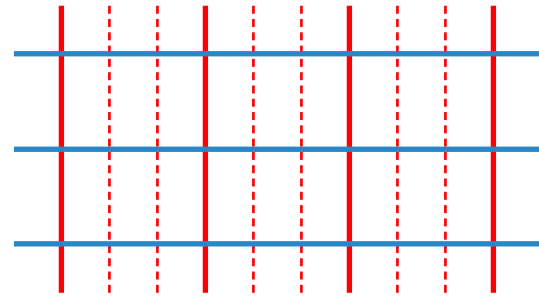

Structural Grid - Then vs. Now

Existing Building Reflection

Penthouse | Roof Monitor | Addition

HOW ARE THE ELEMENTS AT THE TOP OF THE BUILDING TREATED?

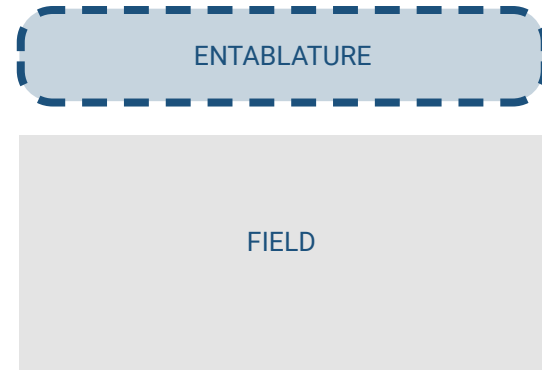

Existing Building Reflection

Treatment of base of building | Connection to ground

HOW DOES THE BUILDING INTERACT WITH THE GROUND?

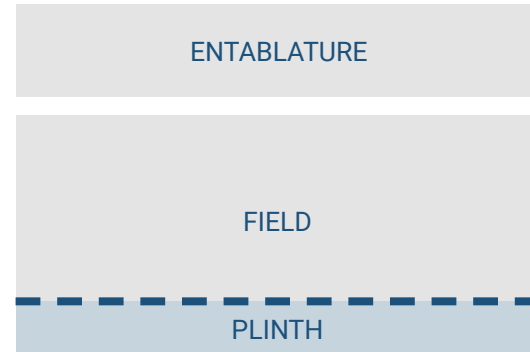

BUILDING STORY INTEGRATION



BUILDING INSET PANELS

BRICK CONTINUATION



Massing - Materials - Textures - Color

COAKLEY MIDDLE SCHOOL MATERIALS PALETTE



ACCENT

\$\$\$ Metal panel cladding

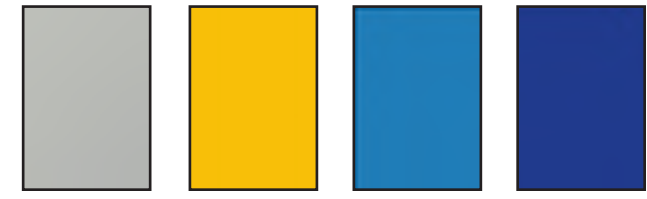

FIELD

\$ Fiber Cement panels

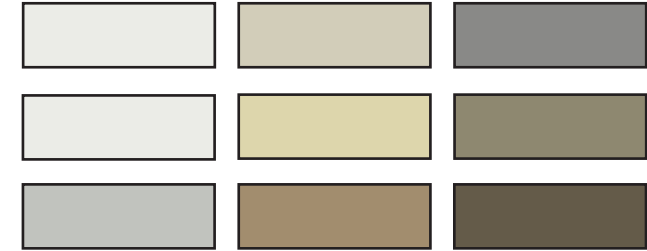

\$\$ Brick

Brick Accent

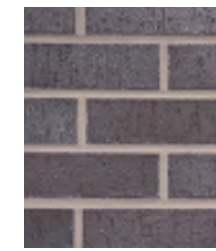

Brick Field



BASE

\$\$

Split-face CMU

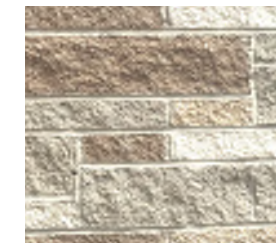

Brick

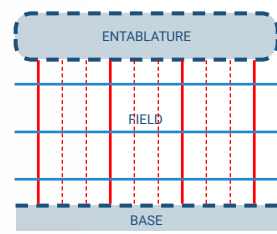

- UTILIZE DURABLE MATERIALS
- PROVIDE IDENTIFIABLE ENTRY POINTS
- HIGHLIGHT SPECIFIC BUILDING ELEMENTS
- REDUCE BUILDING SCALE & MASSING
- RELATE BUILDING AND MATERIALS TO SURROUNDING SITE & TOWN
- PROVIDE BRANDING & IDENTITY FOR STUDENTS
- DESIGN FOR SUSTAINABILITY

Taking the traditional and redefining the limits

South facade of the building

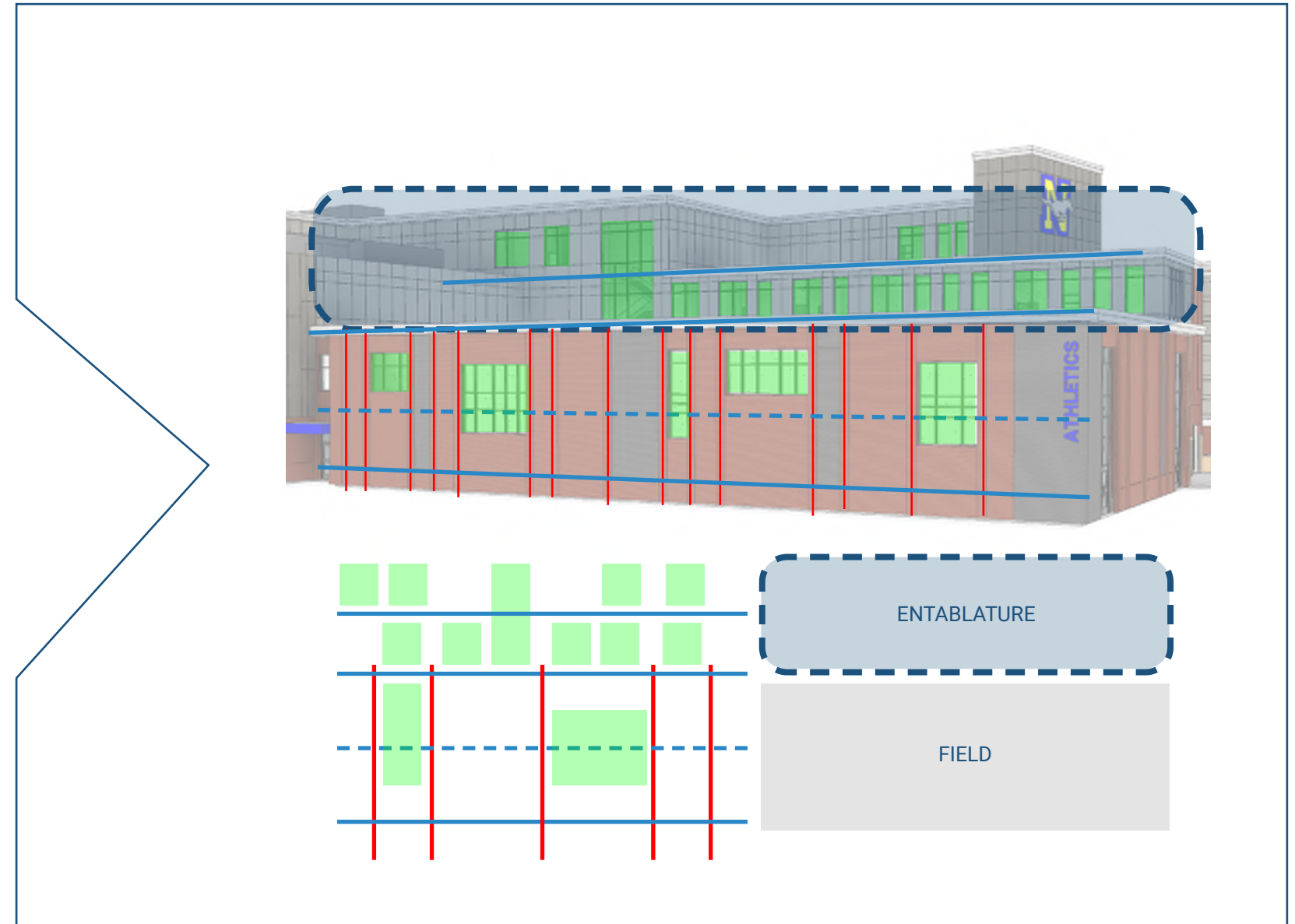
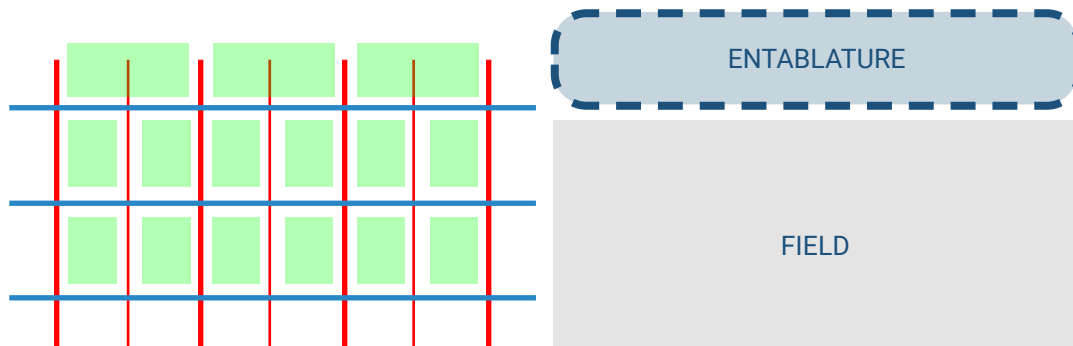

Taking the traditional and redefining the limits

North facade of the building

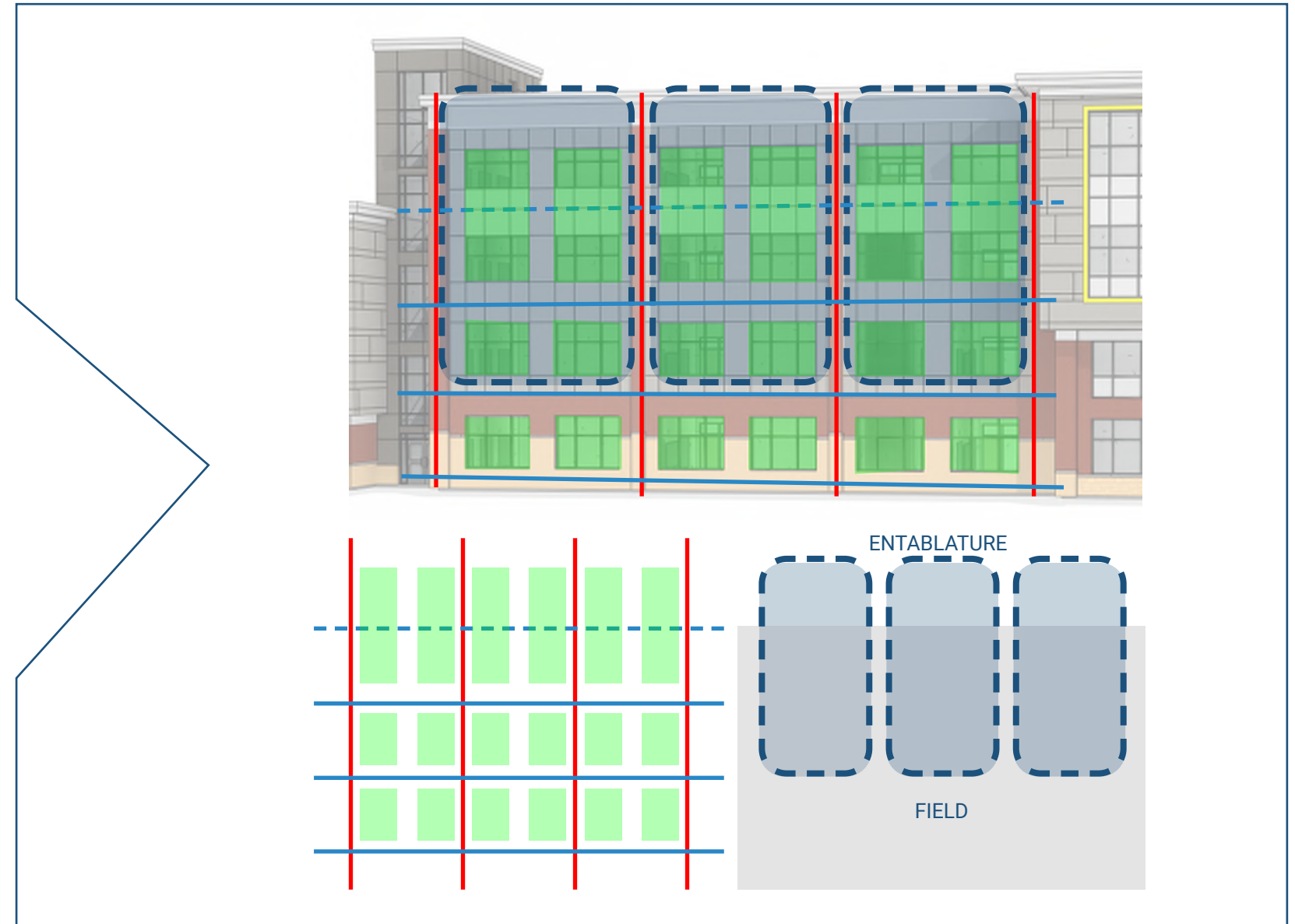
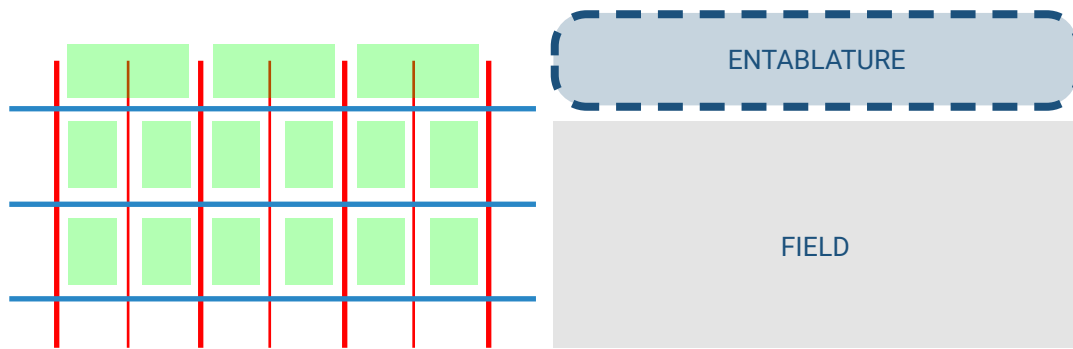



Design Summary

The new Coakley Middle School reflects on references and themes prevalent in the Historical American Mill Buildings throughout the Norwood Community.

The design of the new Coakley Middle School organizes these elements into a modern interpretation of the influential mill building.

The new Coakley Middle School will create a 21st century learning environment that propels the students and staff of Norwood forward; just like the mill buildings propelled the Town forward in the 19th Century.

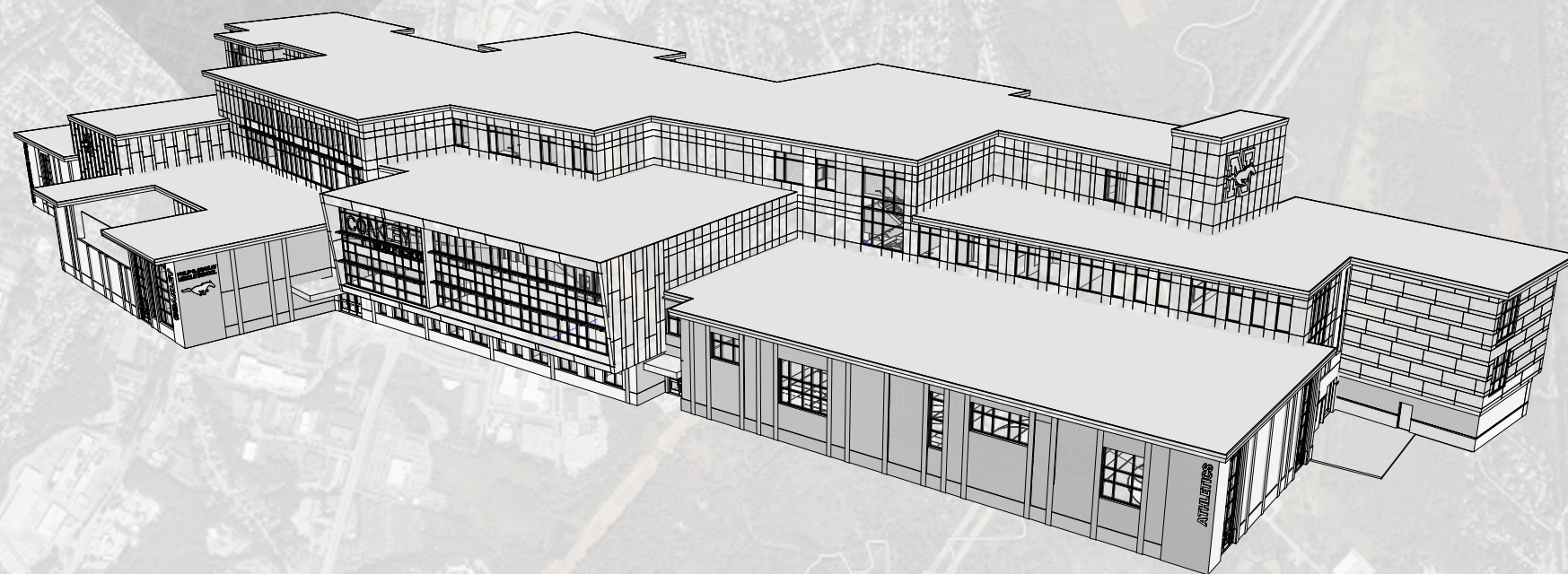

Performing Arts

Student Commons

Admin / Guidance / Nurse & Media Center

Athletics



- UTILIZE DURABLE MATERIALS
- PROVIDE IDENTIFIABLE ENTRY POINTS
- HIGHLIGHT SPECIFIC BUILDING ELEMENTS
- REDUCE BUILDING SCALE & MASSING
- RELATE BUILDING AND MATERIALS TO SURROUNDING SITE & TOWN
- PROVIDE BRANDING & IDENTITY FOR STUDENTS
- DESIGN FOR SUSTAINABILITY

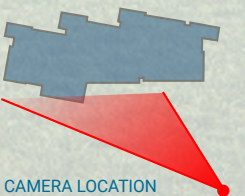

CAMERA LOCATION

Performing Arts

Student Commons

Admin / Guidance /
Nurse & Media Center

Athletics



- UTILIZE DURABLE MATERIALS
- PROVIDE IDENTIFIABLE ENTRY POINTS
- HIGHLIGHT SPECIFIC BUILDING ELEMENTS
- REDUCE BUILDING SCALE & MASSING
- RELATE BUILDING AND MATERIALS TO SURROUNDING SITE & TOWN
- PROVIDE BRANDING & IDENTITY FOR STUDENTS
- DESIGN FOR SUSTAINABILITY



CAMERA LOCATION

Art &
Language

Team 3

Team 2

Team 1

Performing Arts



- UTILIZE DURABLE MATERIALS
- PROVIDE IDENTIFIABLE ENTRY POINTS
- HIGHLIGHT SPECIFIC BUILDING ELEMENTS
- REDUCE BUILDING SCALE & MASSING
- RELATE BUILDING AND MATERIALS TO SURROUNDING SITE & TOWN
- PROVIDE BRANDING & IDENTITY FOR STUDENTS
- DESIGN FOR SUSTAINABILITY

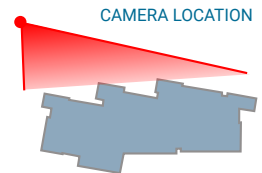

Question & Answer

- ◆ Project Website

- ◆ <https://newcmsproject.org/>

- ◆ Project Email

- ◆ cmsproject@norwoodma.gov

